

1 Important Information

## Getting Started

2 Compatible Controllers

3 Internet Enhancements

4 Note to Parents and Guardians

## Introduction

5 About the Game

6 Starting the Game

7 Saving and Erasing Data

## How to Play

8 Basic Rules and Techniques

9 Controls and Game Screens

10 Two-Player Battles

## About This Product

11 Legal Notices

## Troubleshooting

### 12 Support Information

1

## Important Information

Thank you for selecting Dr. Luigi™ for the Wii U™ system.

### Important Information

Please read this manual carefully before using this software. If the software will be used by children, the manual should be read and explained to them by an adult.

Also, before using this software, please read the content of the  Health and Safety Information application on the Wii U Menu. It contains important information that will help you enjoy this software.

## 2 Compatible Controllers

This software can be used with any of the following controllers once they have been paired with the console.



- ◆ For local two-player games, you will need a Wii U GamePad and either a Wii U Pro Controller, a Wii Remote controller, or a Wii Remote + Classic Controller Pro.
- ◆ Only one Wii U GamePad can be used per console. For online battles between two consoles, each player can use his or her own Wii U GamePad.
- ◆ A Wii Remote Plus can be used instead of a Wii Remote.
- ◆ You can use a Classic Controller™ instead of a Classic Controller Pro™.

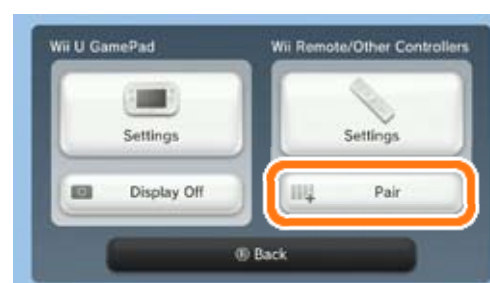

### Pairing Controllers

From the HOME Menu, select **Controller Settings** to display the screen shown to the right. Select **Pair**, and then follow the on-screen instructions to pair the controller.





## 3 Internet Enhancements

Connecting your system to the Internet lets you enjoy the following features:

- Online battles via Nintendo Network 
- Posting to Miiverse
- ◆ See the **Internet Connection Requirements** section of the Wii U Operations Manual for more information about the equipment required to connect to the Internet. Once you have all the required equipment, select **Internet** from  (System Settings) in the Wii U Menu to configure an Internet connection.
- ◆ When you are connected to the Internet, you can use Miiverse to post information, such as your score, high score, and stage-clear time, after finishing a stage.

## 4 Note to Parents and Guardians

You can restrict use of the following features by selecting  (Parental Controls) from the Wii U Menu.

Item	Content
Online Interaction in Games	Restricts online interaction (VS. play on Nintendo Network)  10 .
Miiverse	Restricts features that enable players to post content to and view content on Miiverse. It is possible to restrict posting only or to restrict both posting and viewing.

- ◆ Access to this game (as well as other games) can also be restricted through the **Game Rating** item in Parental Controls.



Dr. Luigi™ is a puzzle game in which you take on the role of Luigi™ and eliminate viruses using capsules. There are three modes to choose from: Retro Remedy, Operation L, and Virus Buster. You can also participate in online battles and track your high scores compared to those of players from all over the world via Nintendo Network.

## 6 Starting the Game

At the title screen, tap the touch screen of the Wii U GamePad or press **A** to display the mode-selection screen. From there, use **+** to select, **A** to confirm, and **B** to cancel as you navigate through the various menus.

◆ In Virus Buster mode, menu controls can be performed using the touch screen.

### 1 Select a Game Mode

To begin a game, first select the game mode you want to play.

#### Retro Remedy / Operation L

In these modes, you use button controls to maneuver capsules with the goal of eliminating all of the viruses inside the bottle. Retro Remedy uses basic capsules, while Operation L uses L-shaped capsules ("L-capsules"). These modes support both single-player games using the Wii U GamePad, and two-player games using the Wii U GamePad and an additional compatible controller

 2 .

#### Virus Buster

In this mode, you use touch controls to maneuver capsules with the goal of eliminating all of the viruses inside the bottle. This mode supports single-player games using the Wii U GamePad.

#### Online Battle

Select this option if you want to compete against friends and fellow players from around the world via Nintendo Network. You can engage in both



Retro Remedy and Operation L matches online.

## ② Set the Number of Players

Once a mode has been selected, a menu will appear that allows you to set the number of players. This menu also presents two other options, which give you the opportunity to view your records and adjust various options before you select a number of players and proceed to the next screen.

### Other Options

#### ● Options

You can change various game settings here.

Quick Drop	If this option is on, you can press up on  to make capsules fall immediately.
Capsule Ghost Image	While this option is on, a ghost image will appear over the spots where capsules will fall.
Virus Design	Use this option to set the viruses' appearance.
Writing Hand (Virus Buster only)	Adjust this setting to indicate the hand with which you write. This will orient the display in a comfortable way.

◆ The Quick Drop and Capsule Ghost Image options are not available in Virus Buster.

#### ● Records

You can view your records and high scores here.

### ③ Select a Game Type

Once a game mode has been selected and the number of players determined, choose which of the following game types you want to play.

Classic (one or two players)	Clear all viruses in a stage to move on. Each time you clear a stage, you will move on to another, more difficult stage. When playing a two-player game, you can win either by clearing all of your viruses first or by holding out until your opponent loses.
Vs. CPU (one player)	Win either by clearing all of your viruses first or by holding out until the CPU loses.
Flash (one or two players)	Win either by clearing all of your flashing viruses first or by holding out until your opponent loses.

- ◆ The option to select a game type is not available in Virus Buster.

### ④ Adjust Final Settings

At the final screen that is displayed before your game begins, you can adjust the difficulty and set the music.



### 1 Level

You can use this setting to adjust how full the bottle is at the start of the game. Moving the cursor to the right increases the initial number of viruses in the bottle.

◆ For Flash games, you have just three level settings to choose from.

### 2 Speed

You can use this setting to adjust the speed at which capsules fall.

◆ For Virus Buster games, a speed is selected by choosing between three difficulty options.

### 3 Music

You can use this setting to change the background music or turn the background music off entirely.

### Saving Data

Game progress is saved automatically whenever a stage is cleared or a battle ends.

### Erasing Data

To erase data, go to Data Management in  (System Settings) on the Wii U Menu and then follow the instructions that appear on the screen.



## 8 Basic Rules and Techniques

Retro Remedy, Operation L, and Virus Buster all share the same basic rules and objective: As the capsules enter the bottle and fall, line them up with like-colored viruses in order to exterminate them. Once all viruses have been removed from the bottle, the current stage is cleared.

### Eliminating Viruses

Move and rotate the capsules as they fall so that they come to rest next to, on top of, or just below viruses of the same color. When you vertically or horizontally align four or more pieces of the same color (capsule pieces and/or virus pieces), they will form a set and all disappear.

#### Vertical Elimination

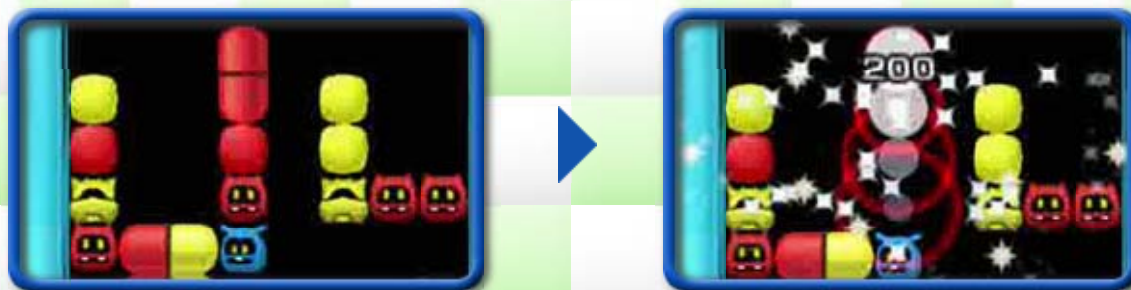

#### Horizontal Elimination



### Techniques

You can eliminate many viruses simultaneously by using techniques called chains and combos. During two-player battles, getting chains and combos will send garbage to your opponent's

bottle.

- ◆ During Operation L two-player matches, pay special attention to which colors it will be most difficult for your opponent to place.

### Chains

When sets of viruses and capsules disappear, any remaining capsule pieces will drop, potentially causing other like-colored capsules and viruses to line up, form sets, and disappear as well. Clearing sets one after the other like this is called a chain.



## Combos

Score combos by eliminating two or more sets at once.



## Game Over

If capsules stack to the top of the bottle, your game will end.



## Virus Buster Techniques

After clearing a set in Virus Buster, you can move any falling capsule pieces that remain in the same way that you move whole capsules.



If you drag a capsule or capsule piece very quickly during a Virus Buster game, you can slide it through viruses and other capsules. This technique makes it possible to fill in open spaces that otherwise seem unreachable.



## Controls during Stages

The following controls are for Retro Remedy and Operation L. When playing Virus Buster, most of these controls are performed using the stylus--tap a capsule to rotate it, and drag-and-drop a capsule to move it.

- ◆ During Virus Buster games, only displaying the Pause menu and rotating the GamePad display require using button controls.



Move capsule	⊕ (left/right)
Rotate capsule clockwise	Ⓐ/ⓐ/②
Rotate capsule counterclockwise	Ⓑ/ⓑ/①
Drop capsule	⊕ (down)
Display Pause menu	⊕
Rotate GamePad display (Virus Buster only)	ⓧ

- ◆ If you turn on Quick Drop in Options, pressing up on ⊕ will instantly drop the current capsule.

## Retro Remedy / Operation L Game Screen

Please note that the screenshot below is from a single-player Retro Remedy game.





1 Score and Time

High Score	Your highest score in a single stage.
Score	Your current score.
Time	Time elapsed since the start of the game.

2 Capsule ghost image

3 Next capsule

4 Level

5 Speed

6 Remaining viruses

## Virus Buster Game Screen



7 Next capsule

8 Level

9 Score and Time

10 Difficulty

11 Current capsule

## Pause Menu

The Pause menu's options allow you to quit, start over, or resume the current stage.



## 10 Two-Player Battles

Retro Remedy and Operation L can be played as two-player battles either locally or via Nintendo Network.



- ◆ Before battling a friend online via Nintendo Network, confirm that you have registered that player to your friend list.

### Local Battles

You can engage in two-player battles during which two players compete side by side on a single console. The battle starts when Player 1 selects the music. After the battle is finished, Player 1 can select Try Again or Quit.

### Online Battles via Nintendo Network

To initiate an online battle or check online records and rankings, select Online Battle at the mode-selection screen. The following options will then be displayed.

Worldwide

Choose this option to connect to the Internet and find an opponent whose rating is close to your own.

Host a Friend

Choose this option to host a game that a friend from your friend list can join.

Join a Friend

Choose this option to join a game hosted by a friend from your friend list. When you select this option, a list of available games will be displayed. Select the one you want to join.

Player  
Rankings

Choose this option to view rankings based on Worldwide-battle results.





## Starting an Online Battle

### ● Worldwide

Once a game mode is selected, you will be matched with someone whose rating is close to your own, and then the battle will begin.

- ◆ You start with a default rating of 5,000. If no opponent with a rating close to yours is available, you may be matched with an opponent whose rating is further from your own.

### ● Host a Friend

Once a game mode is selected, your ID is displayed to your friends when they select Join a Friend. When a friend joins your game, you will be taken to a screen where you can adjust difficulty settings and select the music. The battle will begin when both players have selected music or when the timer reaches zero (whichever comes first).

### ● Join a Friend

Select this option to enter a lobby where you can see available games being hosted by your friends. When a friend elects to host a game and selects a game mode, his or her ID will be displayed in the lobby for you to see. Once you join a friend's game, you will be taken to a screen where you can adjust difficulty settings and select the music. The battle will begin when both players have selected music or when the timer reaches zero (whichever comes first).

## IMPORTANT

This game is not designed for use with any unauthorized device. Use of any such device will invalidate your Nintendo product warranty. Copying and/or distribution of any Nintendo game is illegal and is strictly prohibited by intellectual property laws.

Unauthorized copying or distribution is prohibited. This product contains technical protection measures. Your Wii U system and this software are not designed for use with any unauthorized device or any non-licensed accessory. Such use may be illegal, voids any warranty, and is a breach of your obligations under the End User License Agreement. Further, use of an unauthorized device or software, will render this game or your Wii U system permanently unplayable and result in removal of unauthorized content. Nintendo (as well as any Nintendo licensee or distributor) is not responsible for any damage or loss caused by the use of such device or non-licensed accessory. A system update may be required to play this game.

© 2014 Nintendo.

Trademarks are property of their respective owners.

Wii U is a trademark of Nintendo.

## 12 Support Information

Nintendo Customer Service  
SUPPORT.NINTENDO.COM

USA/Canada:  
1-800-255-3700

Latin America/Caribbean:  
(001) 425-558-7078